



***Trunking & Accessories Guide,  
Product Codes and  
Fitting Instructions***



## 1/2-Round 16 x 8mm Micro Trunking

		White	Magnolia	Aluminium Effect	Black	Oak Effect
<b>Lengths</b>	3.0m Length	R3D1608W	-	-	-	-
	2.0m Length	R2D1608W	R2D1608M	R2D1608A	R2D1608B	R2D1608O
<b>Accessories</b>	Smooth-Fit Internal Bend	IB1608W	IB1608M	IB1608A	IB1608B	IB1608O
	Smooth-Fit External Bend	EB1608W	EB1608M	EB1608A	EB1608B	EB1608O
	Smooth-Fit Flat Bend	FB1608W	FB1608M	FB1608A	FB1608B	FB1608O
	Smooth-Fit Equal Tee	NET1608W	NET1608M	NET1608A	NET1608B	NET1608O
	Smooth-Fit Coupler	NCP1608W	NCP1608M	NCP1608A	NCP1608B	NCP1608O
	Smooth-Fit End Cap	EC1608W	EC1608M	EC1608A	EC1608B	EC1608O



## 1/2-Round 20 x 10mm Micro+ Trunking

		White
<b>Lengths</b>	3.0m Length	R3D2010W
	2.0m Length	R2D2010W
<b>Clip-Over Accessories</b>	Clip-Over Internal Bend	FLIB2010W
	Clip-Over External Bend	FLEB2010W
	Clip-Over Flat Bend	FLFB2010W
	Clip-Over Equal Tee	FLET2010W
<b>Smooth-Fit Accessories</b>	Smooth-Fit Coupler	CP2010W
	Smooth-Fit End Cap	EC2010W



## 1/2-Round 40 x 20mm Mini+ Trunking

		White
<b>Lengths</b>	3.0m Length	R3D4020W
	2.0m Length	R2D4020W
<b>Accessories</b>	Smooth-Fit Internal Bend	IB4020W
	Smooth-Fit External Bend	EB4020W
	Smooth-Fit Flat Bend	FB4020W
	Smooth-Fit Equal Tee	ET4020W
	Smooth-Fit Coupler	CP4020W
	Smooth-Fit End Cap	EC4020W
	Smooth-Fit Box Adaptor Tee	AT4020W



## 1/2-Round 30 x 15mm Mini Trunking

		White	Magnolia	Aluminium Effect	Black	Oak Effect	Red
<b>Lengths</b>	3.0m Length	R3D3015W	R3D3015M	R3D3015A	R3D3015B	R3D3015O	R3D3015R
	2.0m Length	R2D3015W	R2D3015M	R2D3015A	R2D3015B	R2D3015O	-
	3.0m Self Adhesive Internal Divider	3AD3015L	-	-	-	-	-
<b>Clip-Over Accessories</b>	Clip-Over Internal Bend	FLIB3015W	FLIB3015M	FLIB3015A	FLIB3015B	FLIB3015O	FLIB3015R
	Clip-Over External Bend	FLEB3015W	FLEB3015M	FLEB3015A	FLEB3015B	FLEB3015O	FLEB3015R
	Clip-Over Flat Bend	FLFB3015W	FLFB3015M	FLFB3015A	FLFB3015B	FLFB3015O	FLFB3015R
	Clip-Over Door Top Bend	FLDB3015W	FLDB3015M	FLDB3015A	FLDB3015B	FLDB3015O	FLDB3015R
	Clip-Over Equal Tee	FLET3015W	FLET3015M	FLET3015A	FLET3015B	FLET3015O	FLET3015R
	Clip-Over Flat Adaptor	FA3015W	-	-	-	-	FA3015R
<b>Smooth-Fit Accessories</b>	Smooth-Fit Internal Bend	IB3015W	IB3015M	IB3015A	IB3015B	IB3015O	IB3015R
	Smooth-Fit External Bend	EB3015W	EB3015M	EB3015A	EB3015B	EB3015O	EB3015R
	Smooth-Fit Flat Bend	FB3015W	FB3015M	FB3015A	FB3015B	FB3015O	FB3015R
	Smooth-Fit Equal Tee	ET3015W	ET3015M	ET3015A	ET3015B	ET3015O	ET3015R
	Smooth-Fit Cable Outlet	CO3015W	CO3015M	CO3015A	CO3015B	CO3015O	-
	Smooth-Fit Coupler	CP3015W	CP3015M	CP3015A	CP3015B	CP3015O	CP3015R
	Smooth-Fit End Cap	EC3015W	EC3015M	EC3015A	EC3015B	EC3015O	EC3015R
	Smooth-Fit Pattress Adaptor	PA3015W	-	-	-	-	-
	Smooth-Fit Circular Adaptor	CA3015W	-	-	-	-	CA3015R
	Smooth-Fit Box Adaptor	BA3015W	BA3015M	BA3015A	BA3015B	BA3015O	BA3015R
	Smooth-Fit Box Adaptor Tee	AT3015W	AT3015M	AT3015A	AT3015B	AT3015O	-



## 1/2-Round 50 x 25mm TV Trunking

		White	Magnolia	Aluminium Effect	Black	Oak Effect
<b>Lengths</b>	3.0m Length	R3D5025W	-	-	-	-
	2.0m Length	R2D5025W	R2D5025M	R2D5025A	R2D5025B	R2D5025O
	3.0m Self Adhesive Internal Divider	3AD5025L	-	-	-	-
<b>Clip-Over Accessories</b>	Clip-Over Internal Bend	FLIB5025W	FLIB5025M	FLIB5025A	FLIB5025B	FLIB5025O
	Clip-Over External Bend	FLEB5025W	FLEB5025M	FLEB5025A	FLEB5025B	FLEB5025O
	Clip-Over Flat Bend	FLFB5025W	FLFB5025M	FLFB5025A	FLFB5025B	FLFB5025O
	Clip-Over Equal Tee	FLET5025W	FLET5025M	FLET5025A	FLET5025B	FLET5025O
	Clip-Over Box Adaptor Tee	FLAT5025W	FLAT5025M	FLAT5025A	FLAT5025B	FLAT5025O
<b>Smooth-Fit Accessories</b>	Smooth-Fit Internal Bend	IB5025W	IB5025M	IB5025A	IB5025B	IB5025O
	Smooth-Fit External Bend	EB5025W	EB5025M	EB5025A	EB5025B	EB5025O
	Smooth-Fit Flat Bend	FB5025W	FB5025M	FB5025A	FB5025B	FB5025O
	Smooth-Fit Equal Tee	ET5025W	ET5025M	ET5025A	ET5025B	ET5025O
	Smooth-Fit Coupler	CP5025W	CP5025M	CP5025A	CP5025B	CP5025O
	Smooth-Fit End Cap	EC5025W	EC5025M	EC5025A	EC5025B	EC5025O
	Smooth-Fit Reducing Tee (to 30x15mm)	RT5030W	RT5030M	RT5030A	RT5030B	RT5030O
	Smooth-Fit Box Adaptor Tee	AT5025W	AT5025M	AT5025A	AT5025B	AT5025O
<b>10mm Pipe Accessories</b>	Twin 10mm Pipe-Clip Bend	DPP10	-	-	-	-
	Single 10mm Pipe-Clip Bend	SPB10	-	-	-	-
	10mm Pipe Exit End Cap	ECS5025W	-	-	-	-
	10mm Twin Pipe Clip	10PR52	-	-	-	-



## 1/2-Round 60 x 30mm Trunking

		White	Magnolia	Aluminium Effect	Black
<b>Lengths</b>	3.0m Length	R3D6030W	-	-	-
	2.0m Length	R2D6030W	R2D6030M	R2D6030A	R2D6030B
	3.0m Self Adhesive Internal Divider	3AD6030L	-	-	-
<b>Smooth Fit Accessories</b>	Smooth-Fit Internal Bend	IB6030W	IB6030M	IB6030A	IB6030B
	Smooth-Fit External Bend	EB6030W	EB6030M	EB6030A	EB6030B
	Smooth-Fit Flat Bend	FB6030W	FB6030M	FB6030A	FB6030B
	Smooth-Fit Equal Tee	ET6030W	ET6030M	ET6030A	ET6030B
	Smooth-Fit Cable Outlet	CO6030W	CO6030M	CO6030A	CO6030B
	Smooth-Fit Coupler	CP6030W	CP6030M	CP6030A	CP6030B
	Smooth-Fit End Cap	EC6030W	EC6030M	EC6030A	EC6030B
	15mm Twin Pipe Clip	15PR63W	-	-	-



## 1/4-Round 22 x 22mm Trunking/Floor Trim

		White	Oak Effect	Stainable	Light Oak Effect
<b>Lengths</b>	3.0m Length	R3D22QSW	-	-	-
	2.0m Length	R2D22QSW	R2D22QSO	R2D22QSP	R2D22QSF1
<b>Clip-Over Accessories</b>	Clip-Over Internal / Flat Bend	FLIB22QSW	FLIB22QSO	FLIB22QSP	FLIB22QSF1
	Clip-Over External Bend	FLEB22QSW	FLEB22QSO	FLEB22QSP	FLEB22QSF1
	Clip-Over Inlet/Outlet	FLC022QSW	FLC022QSO	FLC022QSP	FLC022QSF1
<b>Smooth-Fit Accessories</b>	Smooth-Fit Internal/Flat Bend	FB22QSW	FB22QSO	FB22QSP	-
	Smooth-Fit External Bend	EB22QSW	EB22QSO	EB22QSP	-
	Smooth-Fit Cable Inlet	CI22QSW	CI22QSO	CI22QSP	-
	Smooth-Fit Cable Outlet	CO22QSW	CO22QSO	CO22QSP	-
	Smooth-Fit Coupler	CP22QSW	CP22QSO	CP22QSP	-
	Smooth-Fit End Cap (left)	EC22QSW/L	EC22QSO/L	EC22QSP/L	EC22QSF1/L
	Smooth-Fit End Cap (right)	EC22QSW/R	EC22QSO/R	EC22QSP/R	EC22QSF1/R



## 1/4-Round 30 x 30mm Trunking

		White	Magnolia	Oak Effect
<b>Lengths</b>	3.0m Length	R3D30QSW	-	-
	2.0m Length	R2D30QSW	R2D30QSM	R2D30QSO
<b>Smooth-Fit Accessories</b>	Smooth-Fit Internal / Flat Bend	FB30QSW	FB30QSM	FB30QSO
	Smooth-Fit External Bend	EB30QSW	EB30QSM	EB30QSO
	Smooth-Fit Cable Outlet	CO30QSW	CO30QSM	CO30QSO
	Smooth-Fit Corner Tee	CT30QSW	-	-
	Smooth-Fit Coupler	CP30QSW	CP30QSM	CP30QSO
	Smooth-Fit Box Adaptor	AT30QSW	-	AT30QSO
	Smooth-Fit Reducing Tee (to 30x15)	RT30QSW	RT30QSM	RT30QSO
	Smooth-Fit End Cap (left)	EC30QSW/L	EC30QSM/L	EC30QSO/L
	Smooth-Fit End Cap (right)	EC30QSW/R	EC30QSM/R	EC30QSO/R

## Colours

W White  
  M Magnolia  
  A Aluminium Effect  
  B Black  
  O Oak Effect  
  R Red  
  P Premium Wood (stainable 22x22 only)\*  
  F1 Light Oak Effect

illustrations not to scale





### Shape & size (wxh)

#### Trunking Lengths

3m Length

2m Length

3m Self Adhesive Divider  
suitable for all colours

								
	<b>60x30mm</b>	<b>50x25mm</b>	<b>40x20mm</b>	<b>30x15mm</b>	<b>20x10mm</b>	<b>16x8mm</b>	<b>22x22mm</b>	<b>30x30mm</b>
3m Length	<input type="checkbox"/>	<input type="checkbox"/>	<input type="checkbox"/>	<input type="checkbox"/>	<input type="checkbox"/>	<input type="checkbox"/>	<input type="checkbox"/>	<input type="checkbox"/>
2m Length	<input type="checkbox"/>	<input type="checkbox"/>	<input type="checkbox"/>	<input type="checkbox"/>	<input type="checkbox"/>	<input type="checkbox"/>	<input type="checkbox"/>	<input type="checkbox"/>
3m Self Adhesive Divider	<input type="checkbox"/>	<input type="checkbox"/>	<input type="checkbox"/>	<input type="checkbox"/>	<input type="checkbox"/>	<input type="checkbox"/>	<input type="checkbox"/>	<input type="checkbox"/>

### Clip-Over Accessories

Flat Bend	<input type="checkbox"/>	<input type="checkbox"/>	<input type="checkbox"/>	<input type="checkbox"/>	<input type="checkbox"/>	<input type="checkbox"/>	<input type="checkbox"/>	<input type="checkbox"/>
Internal Bend	<input type="checkbox"/>	<input type="checkbox"/>	<input type="checkbox"/>	<input type="checkbox"/>	<input type="checkbox"/>	<input type="checkbox"/>	<input type="checkbox"/>	<input type="checkbox"/>
External Bend	<input type="checkbox"/>	<input type="checkbox"/>	<input type="checkbox"/>	<input type="checkbox"/>	<input type="checkbox"/>	<input type="checkbox"/>	<input type="checkbox"/>	<input type="checkbox"/>
Equal Tee	<input type="checkbox"/>	<input type="checkbox"/>	<input type="checkbox"/>	<input type="checkbox"/>	<input type="checkbox"/>	<input type="checkbox"/>	<input type="checkbox"/>	<input type="checkbox"/>
Door Top Bend	<input type="checkbox"/>	<input type="checkbox"/>	<input type="checkbox"/>	<input type="checkbox"/>	<input type="checkbox"/>	<input type="checkbox"/>	<input type="checkbox"/>	<input type="checkbox"/>
Box Adaptor Tee (50x25 only)	<input type="checkbox"/>	<input type="checkbox"/>	<input type="checkbox"/>	<input type="checkbox"/>	<input type="checkbox"/>	<input type="checkbox"/>	<input type="checkbox"/>	<input type="checkbox"/>
Inlet/Outlet Coupler (22x22 only)	<input type="checkbox"/>	<input type="checkbox"/>	<input type="checkbox"/>	<input type="checkbox"/>	<input type="checkbox"/>	<input type="checkbox"/>	<input type="checkbox"/>	<input type="checkbox"/>
Flat Adaptor	<input type="checkbox"/>	<input type="checkbox"/>	<input type="checkbox"/>	<input type="checkbox"/>	<input type="checkbox"/>	<input type="checkbox"/>	<input type="checkbox"/>	<input type="checkbox"/>

### Smooth Fit Accessories

Flat Bend	<input type="checkbox"/>	<input type="checkbox"/>	<input type="checkbox"/>	<input type="checkbox"/>	<input type="checkbox"/>	<input type="checkbox"/>	<input type="checkbox"/>	<input type="checkbox"/>
Internal Bend	<input type="checkbox"/>	<input type="checkbox"/>	<input type="checkbox"/>	<input type="checkbox"/>	<input type="checkbox"/>	<input type="checkbox"/>	<input type="checkbox"/>	<input type="checkbox"/>
External Bend	<input type="checkbox"/>	<input type="checkbox"/>	<input type="checkbox"/>	<input type="checkbox"/>	<input type="checkbox"/>	<input type="checkbox"/>	<input type="checkbox"/>	<input type="checkbox"/>
Equal Tee	<input type="checkbox"/>	<input type="checkbox"/>	<input type="checkbox"/>	<input type="checkbox"/>	<input type="checkbox"/>	<input type="checkbox"/>	<input type="checkbox"/>	<input type="checkbox"/>
Cable Outlet	<input type="checkbox"/>	<input type="checkbox"/>	<input type="checkbox"/>	<input type="checkbox"/>	<input type="checkbox"/>	<input type="checkbox"/>	<input type="checkbox"/>	<input type="checkbox"/>
Cable Inlet	<input type="checkbox"/>	<input type="checkbox"/>	<input type="checkbox"/>	<input type="checkbox"/>	<input type="checkbox"/>	<input type="checkbox"/>	<input type="checkbox"/>	<input type="checkbox"/>
Reducing Tee (to 30x15mm)	<input type="checkbox"/>	<input type="checkbox"/>	<input type="checkbox"/>	<input type="checkbox"/>	<input type="checkbox"/>	<input type="checkbox"/>	<input type="checkbox"/>	<input type="checkbox"/>
Coupler	<input type="checkbox"/>	<input type="checkbox"/>	<input type="checkbox"/>	<input type="checkbox"/>	<input type="checkbox"/>	<input type="checkbox"/>	<input type="checkbox"/>	<input type="checkbox"/>
End Cap	<input type="checkbox"/>	<input type="checkbox"/>	<input type="checkbox"/>	<input type="checkbox"/>	<input type="checkbox"/>	<input type="checkbox"/>	<input type="checkbox"/>	<input type="checkbox"/>
End Cap Left (¼ round only)	<input type="checkbox"/>	<input type="checkbox"/>	<input type="checkbox"/>	<input type="checkbox"/>	<input type="checkbox"/>	<input type="checkbox"/>	<input type="checkbox"/>	<input type="checkbox"/>
End Cap Right (¼ round only)	<input type="checkbox"/>	<input type="checkbox"/>	<input type="checkbox"/>	<input type="checkbox"/>	<input type="checkbox"/>	<input type="checkbox"/>	<input type="checkbox"/>	<input type="checkbox"/>
10mm Pipe Exit End Cap	<input type="checkbox"/>	<input type="checkbox"/>	<input type="checkbox"/>	<input type="checkbox"/>	<input type="checkbox"/>	<input type="checkbox"/>	<input type="checkbox"/>	<input type="checkbox"/>
Corner Tee	<input type="checkbox"/>	<input type="checkbox"/>	<input type="checkbox"/>	<input type="checkbox"/>	<input type="checkbox"/>	<input type="checkbox"/>	<input type="checkbox"/>	<input type="checkbox"/>
Box Adaptor Tee	<input type="checkbox"/>	<input type="checkbox"/>	<input type="checkbox"/>	<input type="checkbox"/>	<input type="checkbox"/>	<input type="checkbox"/>	<input type="checkbox"/>	<input type="checkbox"/>
30x15mm Box Adaptor	<input type="checkbox"/>	<input type="checkbox"/>	<input type="checkbox"/>	<input type="checkbox"/>	<input type="checkbox"/>	<input type="checkbox"/>	<input type="checkbox"/>	<input type="checkbox"/>
Patress Adaptor	<input type="checkbox"/>	<input type="checkbox"/>	<input type="checkbox"/>	<input type="checkbox"/>	<input type="checkbox"/>	<input type="checkbox"/>	<input type="checkbox"/>	<input type="checkbox"/>
Circular Adaptor	<input type="checkbox"/>	<input type="checkbox"/>	<input type="checkbox"/>	<input type="checkbox"/>	<input type="checkbox"/>	<input type="checkbox"/>	<input type="checkbox"/>	<input type="checkbox"/>

### Safe-D Clips - Fire Rated

SAFE-D30 (BS5839 part 1)	<input type="checkbox"/>	<input type="checkbox"/>	<input type="checkbox"/>	<input type="checkbox"/>	<input type="checkbox"/>	<input type="checkbox"/>	<input type="checkbox"/>	<input type="checkbox"/>
SAFE-D40 (BS5839 part 1)	<input type="checkbox"/>	<input type="checkbox"/>	<input type="checkbox"/>	<input type="checkbox"/>	<input type="checkbox"/>	<input type="checkbox"/>	<input type="checkbox"/>	<input type="checkbox"/>
SAFE-D50 (BS5839 part 1)	<input type="checkbox"/>	<input type="checkbox"/>	<input type="checkbox"/>	<input type="checkbox"/>	<input type="checkbox"/>	<input type="checkbox"/>	<input type="checkbox"/>	<input type="checkbox"/>

### Surface Boxes

28mm Deep Single	<input type="checkbox"/>
28mm Deep Twin	<input type="checkbox"/>
35mm Deep Single	<input type="checkbox"/>
35mm Deep Twin	<input type="checkbox"/>
28mm Rounded Single	<input type="checkbox"/>
28mm Rounded Twin	<input type="checkbox"/>
35mm Rounded Single	<input type="checkbox"/>
35mm Rounded Twin	<input type="checkbox"/>

Clip-Over  
Accessories



Smooth Fit  
Accessories



\* All oak/wood trunking accessories are brown finish, but can be stained to achieve best colour co-ordination to stained lengths (key surface of accessory with fine abrasive prior to staining)

## 1/2-Round Clip-Over Accessories - For 20x10mm, 30x15mm and 50x25mm only



**Internal Bend**

Join lengths around 90 degree inside corners.



**External Bend**

Join lengths around 90 degree outside corners.

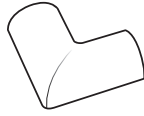

**Flat Bend**

Change direction by 90 degrees on flat surfaces.

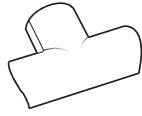

**Equal Tee**

Use to join 3 lengths of same profile.

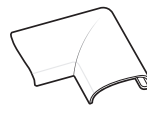

**Door Top Bend**

Change direction by 90 degrees around frame tops.



**Box Adaptor Tee**

For use with D-Line Surface Socket Boxes. **50 x 25mm only**

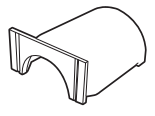

**Flat Adaptor**

Connect Mini Trunking to flat surfaces **30 x 15mm only**

## 1/4-Round Clip-Over Accessories - For 22x22mm only



**Internal Bend**

Join lengths around 90 degree inside corners.



**External Bend**

Join lengths around 90 degree outside corners.



**Cable Inlet/Outlet**

Use to provide cable entry/exit point between 2 lengths.



**Use with Smooth-Fit Couplers & End Caps**

## 1/2-Round Smooth-Fit Accessories

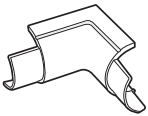

**Internal Bend**

Join lengths around 90 degree inside corners.

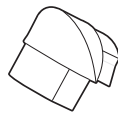

**External Bend**

Join lengths around 90 degree outside corners.

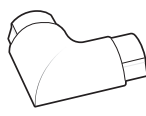

**Flat Bend**

Change direction by 90 degrees on flat surfaces.

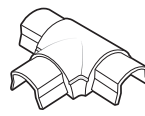

**Equal Tee**

Use to join 3 lengths of same profile.

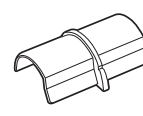

**Coupler**

Join 2 lengths of same profile on flat surface.

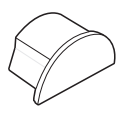

**End Cap**

Neatly finish open ends.



**Pattress Adaptor**

Connect Mini Trunking to round surface pattresses. **30 x 15mm only**

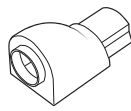

**Circular Adaptor**

Connect Mini Trunking to flat edge surfaces with 20mm Ø knock-outs. **30 x 15mm only**

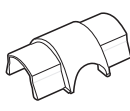

**Cable Inlet/Outlet**

Takes cables in or out of a Mini Trunking. Use between lengths on straight runs. **30 x 15mm only**

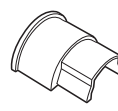

**Box Adaptor**

For use with D-Line Surface Socket Boxes. **30 x 15mm only**

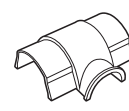

**Box Adaptor Tee**

For use with D-Line Surface Socket Boxes.

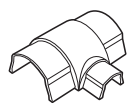

**Reducing Tee**

Connect to 30 x 15mm Mini Trunking.

## 1/4-Round Smooth-Fit Accessories



**Internal Bend**

Join lengths around 90 degree inside corners.

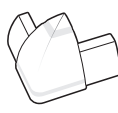

**External Bend**

Join lengths around 90 degree outside corners.

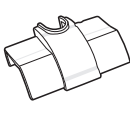

**Cable Inlet**

Use to provide cable entry point between 2 lengths.

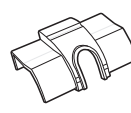

**Cable Outlet**

Use to provide cable exit point between 2 lengths.

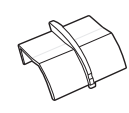

**Coupler**

Joins 2 lengths on flat surfaces.

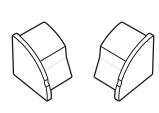

**End Cap**

Neatly finish open ends (left & right versions apply).

## Other Accessories

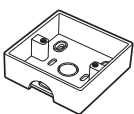

**Single Surface Socket Box**

For use with 30 x 15mm, 40 x 20mm & 50 x 25mm Trunking. Available in 28mm & 35mm depth.

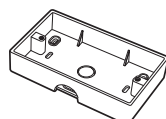

**Twin Surface Socket Box**

For use with 30 x 15mm, 40 x 20mm & 50 x 25mm Trunking. Available in 28mm & 35mm depth.



**SAFE-D30 Clip**

Fire rated cable clip for use with 30 x 15mm D-Line & 25mm+ wide traditional trunkings. Safe-D Red version also available.

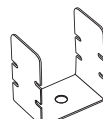

**SAFE-D40 Clip**

Fire rated cable clip for use with 40 x 20mm & 50 x 25mm D-Line & 40mm+ wide traditional trunkings.

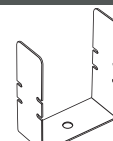

**SAFE-D50 Clip**

Fire rated cable clip for use with 60 x 30mm D-Line & 50mm+ wide traditional trunkings.



**Ratchet Cutting Tool**

Use to cut up to 40mm wide D-Line Trunking.





# Fitting Guide for 1/2 round D-Line

# D-LINE®

## Measuring up

Plan your cable path. Check that you have all parts required. Next consider the space that will be needed for any accessories needed.

**Clip-Over** accessories allow a tolerance for imprecise measurements and untidy cuts.

**Smooth Fit** accessories give a smooth flush-alignment for perfect finish, but require precise measurements and straight cuts.

For Smooth fit use the accessory part as a template; pencil mark the surface at the shoulder points of the accessory.

These pencil marks indicate the point that the D-Line length needs to measure up to.

### Clip-Over example...



### Smooth fit example...

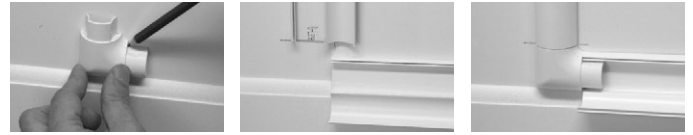

## Cutting & Installing Lengths

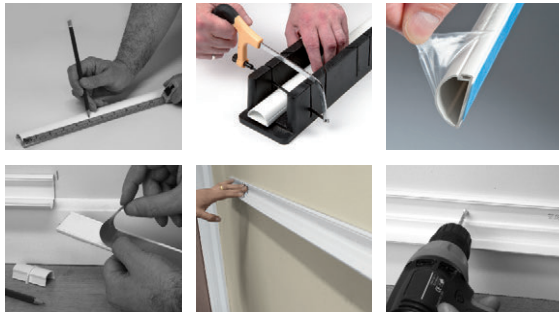

- Measure length(s). Pencil mark where cut is required.
- Use a mitre block and junior hacksaw to cut at the outer edge of the pencil mark.
- Remove the protective film cover.
- To peel & stick... Make sure the surface is clean & dry. Alternatively lengths can be drilled and screw fixed; as recommended for profiles with bases wider than 35mm.
- For easier installation we recommend that horizontal runs are fixed with the click lock at the top and the hinge at the base.
- Take care when positioning lengths, as a strong bond will be created with the surface.

## Installing cables & accessories

### Clip-Over

Lay cables into lengths, close the lid ensuring it snaps shut, then clip the accessory in place. The tabs clip over the top of the lengths.

#### Internal Bend



#### External Bend



#### Flat Bend

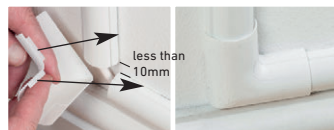

#### Equal Tee



#### Door Top Bend



**NOTE:** some Clip-Over accessories have a section of self adhesive tape applied to the reverse. This helps secure the piece in place, please use if necessary.

## After Care

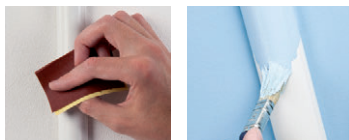

D-Line can accept gloss or emulsion paints... For best results use fine sandpaper to key the surface prior to painting.

### Smooth Fit

Lay cables into lengths, place the required accessory over the cables, then close the lid ensuring it snaps shut.

The lengths hold the accessories in position.

#### Internal Bend

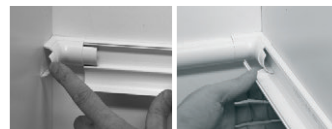

#### External Bend

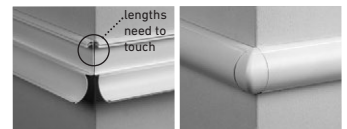

#### Flat Bend



#### Equal Tee



#### Cable Inlet/Outlet



#### Connector

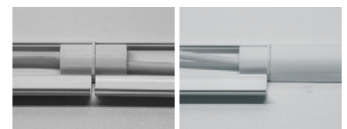

#### End Cap

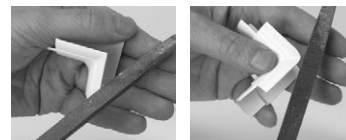
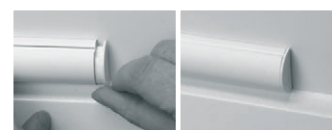

It may be necessary to shape some accessories to allow for imperfections on walls.

**Important:** If using D-Line for high voltage mains cables it is recommended you leave 45%+ of internal capacity for air circulation.



# Fitting Guide for 1/4 round D-Line



## Measuring Up

Plan your cable path. Check that you have all parts required. Next consider the space that will be needed for any accessories needed.

**Clip-Over** accessories allow a tolerance for imprecise measurements and untidy cuts.

**Smooth Fit** accessories give a smooth flush-alignment for perfect finish, but require precise measurements and straight cuts.

For Smooth fit use the accessory part as a template; pencil mark the surface at the shoulder points of the accessory.

These pencil marks indicate the point that the D-Line length needs to measure up to.

### Clip-Over example...



### Smooth fit example...



## Cutting & Installing Lengths

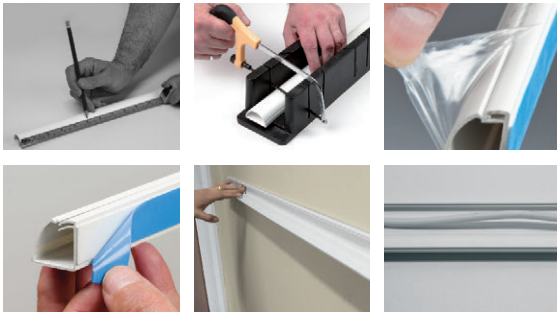

- Measure length(s). Pencil mark where cut is required.
- Use a mitre block and junior hacksaw to cut at the outer edge of the pencil mark.
- Remove the protective film cover.
- To peel & stick... Make sure the surface is clean & dry.
- Horizontal runs should be fixed with the click lock at the top and the hinge at the base as shown to the right.
- Take care when positioning lengths, as a strong bond will be created with the surface.



## Installing cables & accessories

### Clip-Over

Lay cables into lengths, close the lid ensuring it snaps shut, then clip the accessory in place. The tabs clip over the top of the lengths.

#### Internal Bend



#### External Bend



#### Connector / Cable Inlet

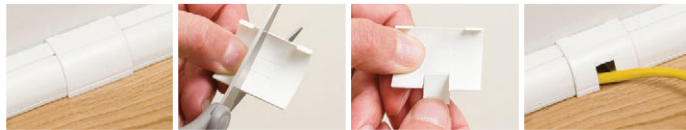

NOTE: some Clip-Over accessories have a section of self adhesive tape applied to the reverse. This helps secure the piece in place, please use if necessary.

### After Care

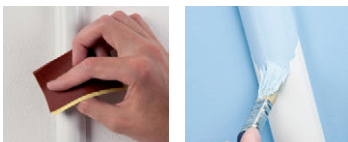

D-Line can accept gloss or emulsion paints... For best results use fine sandpaper to key the surface prior to painting.

### Smooth Fit

Lay cables into lengths, place the required accessory over the cables, then close the lid ensuring it snaps shut.

The lengths hold the accessories in position.

#### Internal Bend



#### External Bend



#### Cable Inlet/Outlet

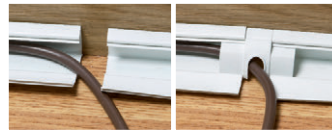

#### Connector

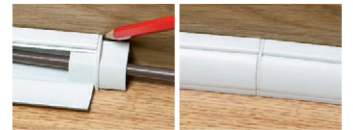

#### End Cap



Note: there are left and right sided end caps



It may be necessary to shape some accessories to allow for imperfections on walls.

**Important:** If using D-Line for high voltage mains cables it is recommended you leave 45%+ of internal capacity for air circulation.

**D-LINE®**

***D-Line (Europe) Limited***

**Unit A5 Tromso Close, Tyne Tunnel Trading Estate, North Shields, Tyne & Wear NE29 7XH United Kingdom**

**Tel: +44 (0)191 236 0960   Sales: +44 (0)191 237 9156   Finance: +44 (0)191 237 9157   Customer Services: +44 (0)191 237 9158**

**Fax: +44 (0)191 236 0979   Email: [enquiries@d-line-it.com](mailto:enquiries@d-line-it.com)   Web: [www.d-line-it.com](http://www.d-line-it.com)**